



SOUTH SHETLAND ISLANDS AND ANTARCTIC PENINSULA

Experience incredible wildlife, stunning scenery and gigantic icebergs

10 Days

From Ushuaia

M/V Ocean Victory

2, 29 Nov, 2025
12 Feb, 2026

Adventure Options



Storied and sought for centuries, the great White Continent beckons intrepid modern-day explorers from all over the world. Experience incredible wildlife, stunning scenery and gigantic icebergs in action-packed days on the Last Continent on our classic 10-day voyage to the Antarctic Peninsula.

Join us onboard our purpose-built, ice-class expedition vessels, Ocean Victory and Ocean Albatros to experience the majesty and wonder of Earth's last frontier up close and personal. Our vessels enable us to get closer to nature, with a fleet of Zodiac landing craft, a team of experienced expert expedition guides, and the Antarctic Peninsula as our spectacular destination.

Departing Argentina's southernmost city of Ushuaia, we cross the mighty Drake Passage en-route to the South Shetland Islands, aiming to arrive on the afternoon of the third day of our voyage (weather permitting).

Continuing southward from the South Shetland Islands, we will delve deeper into the inlets and bays of the Antarctic Peninsula, entering the famous Gerlache Strait, where glittering ice cliffs and precipitous peaks rise straight out of the frigid water. Icebergs, glaciers, mountains and rugged snowfields characterise this wildly beautiful alien landscape.

On no other journey can you experience so much pristine nature and varied wildlife in such a short time. Our skilled Captain and Expedition Leader will work hard to maximise opportunities to explore the White Continent. While wind, sea and ice conditions will dictate the exact locations we will visit, we will make Zodiac landings to allow guests to set foot on land and experience penguin rookeries, research stations and historical sites, and aim to Zodiac cruise in scenic areas filled with giant icebergs, whales and seals. Jaw-dropping scenery and landscapes are guaranteed!

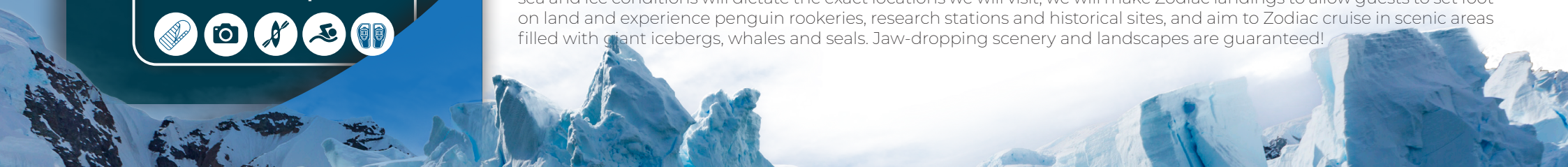

ITINERARY

- DAY 1** Arrival In Ushuaia, Embarkation
- DAY 2-3** At Sea - Crossing The Drake Passage Southbound
- DAY 4-7** South Shetland Islands & The Antarctic Peninsula
- DAY 8-9** At Sea - Crossing The Drake Passage Northbound
- DAY 10** Back To Ushuaia And Disembarkation



INCLUSIONS

- 10-day cruise with accommodation in a shared double stateroom featuring ensuite facilities
- Embarkation shuttle transfer to the vessel from Ushuaia city centre
- Shuttle transfer after disembarkation from the ship to Ushuaia city centre or airport
- All Zodiac landings and excursions, as per itinerary, guided by our Expedition Team
- Expedition parka
- Rubber boots loan scheme
- Briefings and lectures by our Expedition Leader and Team
- English-speaking Expedition Team
- Full board on the ship - breakfast, lunch, dinner and snacks
- Complimentary house wine, beer and soda at dinner (selected labels and brands, served at our a-la-carte dinners)
- Free tea and coffee available 24 hours
- Taxes and landing fees
- Special photo workshops
- Welcome and Farewell Cocktail Parties
- Digital visual journal link distributed after the voyage, including voyage log, gallery, species list and more!



A TYPICAL DAY

- After crossing the Drake Passage, you'll be exploring Antarctica. The goal for the days around the South Shetland islands and Antarctic peninsula is to offer activities which will allow everyone to explore off the ship as much as possible (weather permitting). Weather dependent, we will try to offer two activities per day, usually either a landing or a Zodiac cruise.
- A "TYPICAL" EXPEDITION DAY MAY LOOK LIKE THIS (SUBJECT TO WEATHER AND SEA CONDITIONS AND SAILING SCHEDULE):
- 06.45: Wake-up call
- 07.00-08.00: Breakfast
- 08.30-11.30: Morning activity - landing and/or Zodiac cruise
- 12.30-13.30: Lunch during vessel repositioning
- 14.30-17.30: Afternoon Activity - landing and/or Zodiac cruise
- 18.30-19.30: Evening Recap and Briefing with the Expedition Team
- 19.30: Dinner
- 21.00: Evening entertainment or presentations with the Expedition Team.



OCEAN VICTORY DECKPLAN

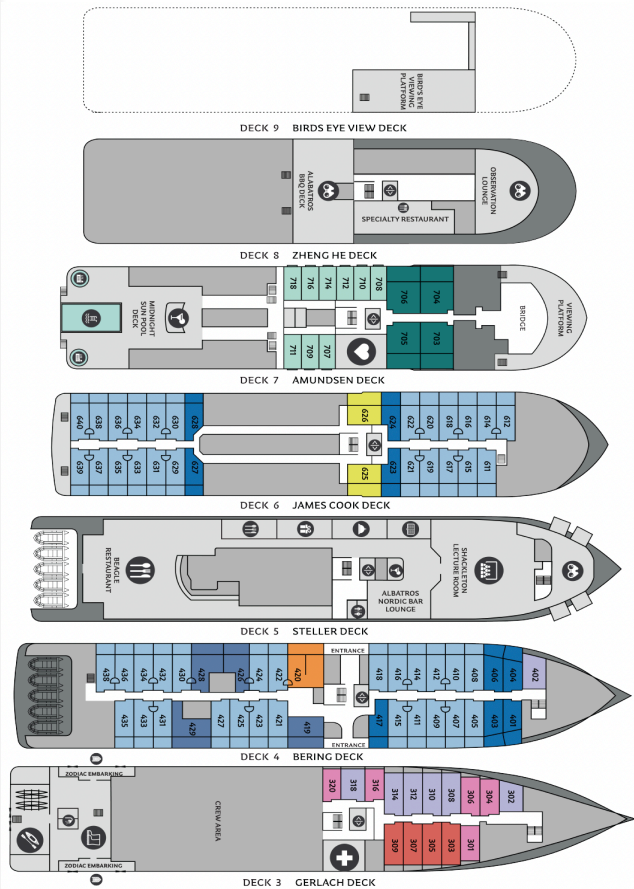

FACILITIES

- 2 Restaurants and 1 Open Deck Dining
- Observation Lounge
- Lecture Lounge
- Piano Bar
- Gym, Spa & Sauna Facilities
- Polar Library
- Albatros Ocean Boutique
- Changing Facilities for Zodiac Excursions
- 18 Zodiacs
- Pool Bar

Premium Suite, Two Bedroom Suite
1 Cabin, Size 45 sqm incl. Balcony

Category A, Junior Suite
4 Cabins, Size 42 sqm incl. Balcony

Category B, Balcony Suite
2 Cabins, Size app. 32 sqm incl. Balcony

Category C XL, Grand Balcony Stateroom
4 Cabins, Size 30 sqm incl. Balcony

Category C SP, Superior Balcony Stateroom
48 Cabins, Size 24 sqm incl. Balcony

Category C, Balcony Stateroom
9 Cabins, Size 22 sqm incl. Balcony

Category D, Porthole Stateroom
7 Cabins, Size 22 sqm

Category E, French Balcony C Stateroom
9 Cabins, Size 16 sqm

Category F, Triple Porthole Stateroom
4 Cabins, Size 22 sqm

Category G, Porthole Single Stateroom
5 Cabins, Size 18 sqm

- | | | | | |
|-------------------------|-------------------------|--------------------|------------------|----------|
| Restaurant | Knud Rasmussen Library | Fitness | Mudroom | Elevator |
| Bar | Albatros Ocean Boutique | Albatros Polar Spa | Zodiac embarking | Shower |
| Observation Area | Reception | Infinity Pool | Kayak platform | Stairs |
| Shackleton Lecture Room | Medical Clinic | Jacuzzi | Toilet | |



ROOM CATEGORIES



CATEGORY PS
Polar Premium Suite (1)
45 sqm, incl. Balcony



CATEGORY A
Junior Suite (4)
42 sqm, incl. Balcony



CATEGORY B
Balcony Suite (2)
app. 32 sqm, incl. Balcony

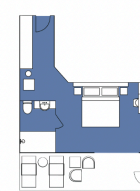

CATEGORY C XL
Grand Balcony Stateroom (4)
app. 30 sqm, incl. Balcony



CATEGORY C SP
Superior Balcony Stateroom(48)
24 sqm, incl. Balcony



CATEGORY C
Balcony Stateroom(9)
22 sqm, incl. Balcony



CATEGORY D
Albatros Stateroom(7)
22 sqm, Porthole



CATEGORY E
French Balcony Stateroom(9)
16 sqm, French Balcony



CATEGORY F
Triple Stateroom(4)
22 sqm, Porthole



CATEGORY G
Single Stateroom(5)
18 sqm, Porthole

