



# FALKLAND ISLANDS, SOUTH GEORGIA & ANTARCTICA

Experience incredible wildlife, stunning scenery and gigantic icebergs

18 Days

From Ushuaia

Ocean Victory

18 Dec, 2024

Adventure Options



On this extraordinary 18-day voyage, explore the fascinating Falkland Islands and mind-blowing South Georgia before heading to the South Shetlands Islands and the Antarctic peninsula. All the highlights of the Southern Ocean!

Departing Argentina's southernmost city of Ushuaia, we will venture east towards the Falkland Islands (Malvinas). A British Overseas Territory, the Falklands are a unique blend of British culture (expect tea and red phone boxes) and southern wildness, where penguins cavort alongside sheep on former battlefields.

From the Falklands, we venture onwards to South Georgia. A strip of jagged glacier-clad mountains piercing the brooding sky, South Georgia leaves a mark on every visitor, and it is no mystery why. The shores brim with wildlife, with thousands of King Penguins, elephant seals and Antarctic fur seals. The vast penguin colonies, seal-filled seas and albatross-packed skies have to be seen to be believed.

Continuing southward, we will delve deeper into the inlets and bays of the Antarctic Peninsula, entering the famous Gerlache Strait, where glittering ice cliffs and precipitous peaks rise straight out of the frigid water. Icebergs, glaciers, mountains and rugged snowfields characterise this wildly beautiful alien landscape. We always aim to visit locations which showcase the best of Antarctica, and we are always on the lookout for wildlife; feathered friends and jaw-dropping scenery and landscapes are guaranteed!

Any voyage in the Southern Ocean is an adventure, but with an average occupancy of 175 guests aboard Ocean Victory and Ocean Albatros, our cruises offer a unique experience for the brave few. Shore landings and Zodiac safaris will occupy our days, while our knowledgeable onboard Expedition Team will offer a selection of specially crafted lectures to inform your matchless expedition experience.

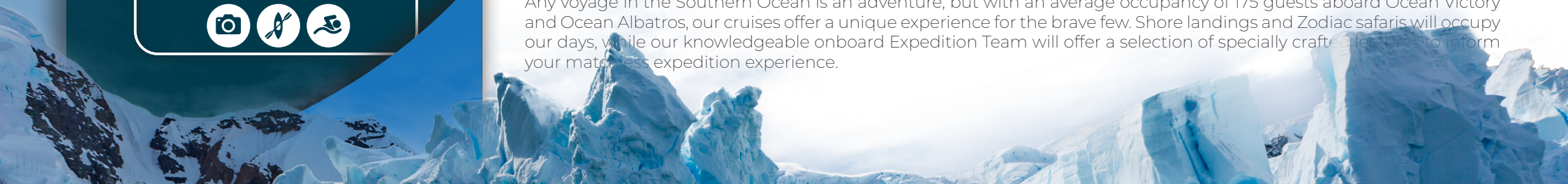

# ITINERARY

- DAY 1** Arrival and Embarkation in Ushuaia
- DAY 2** At Sea Towards The Falkland Islands
- DAY 3** Falkland Islands
- DAY 4** Falkland Islands
- DAY 5-6** At Sea, En Route to South Georgia
- DAY 7** South Georgia
- DAY 8** South Georgia
- DAY 9** South Georgia
- DAY 10-11** At Sea
- DAY 12** Elephant Island
- DAY 13** Antarctic Peninsula
- DAY 14** Antarctic Peninsula
- DAY 15** Antarctic Peninsula
- DAY 16-17** Crossing the Drake Passage Towards Ushuaia
- DAY 18** Arrival in Ushuaia and Disembarkation



## INCLUSIONS

- 18-day/17-night cruise with accommodation in a shared double stateroom featuring ensuite facilities
- Embarkation shuttle transfer to the vessel from Ushuaia city centre
- Shuttle transfer after disembarkation from the ship to Ushuaia city centre or airport
- All Zodiac landings and excursions, as per itinerary, guided by our Expedition Team
- Expedition parka
- Rubber boots loan scheme
- Briefings and lectures by our Expedition Leader and Team
- English-speaking Expedition Team
- Full board on the ship - breakfast, lunch, dinner and snacks
- Complimentary house wine, beer and soda at dinner (selected labels and brands, served at our a-la-carte dinners)
- Free tea and coffee available 24 hours
- Taxes and landing fees
- Special photo workshops
- Welcome and Farewell Cocktail Parties
- Digital visual journal link distributed after the voyage, including voyage log, gallery, species list and more!



## A TYPICAL DAY

- After crossing the Drake Passage, you'll be exploring Antarctica. The goal for the days around the South Shetland islands and Antarctic peninsula is to offer activities which will allow everyone to explore off the ship as much as possible (weather permitting). Weather dependent, we will try to offer two activities per day, usually either a landing or a Zodiac cruise.
- A "TYPICAL" EXPEDITION DAY MAY LOOK LIKE THIS (SUBJECT TO WEATHER AND SEA CONDITIONS AND SAILING SCHEDULE):
- 06:45: Wake-up call
- 07:00-08:00: Breakfast
- 08:30-11:30: Morning activity - landing and/or Zodiac cruise
- 12:30-13:30: Lunch during vessel repositioning
- 14:30-17:30: Afternoon Activity - landing and/or Zodiac cruise
- 18:30-19:30: Evening Recap and Briefing with the Expedition Team
- 19:30: Dinner
- 21:00: Evening entertainment or presentations with the Expedition Team.

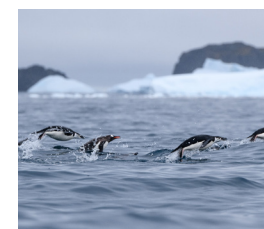

# OCEAN VICTORY DECKPLAN

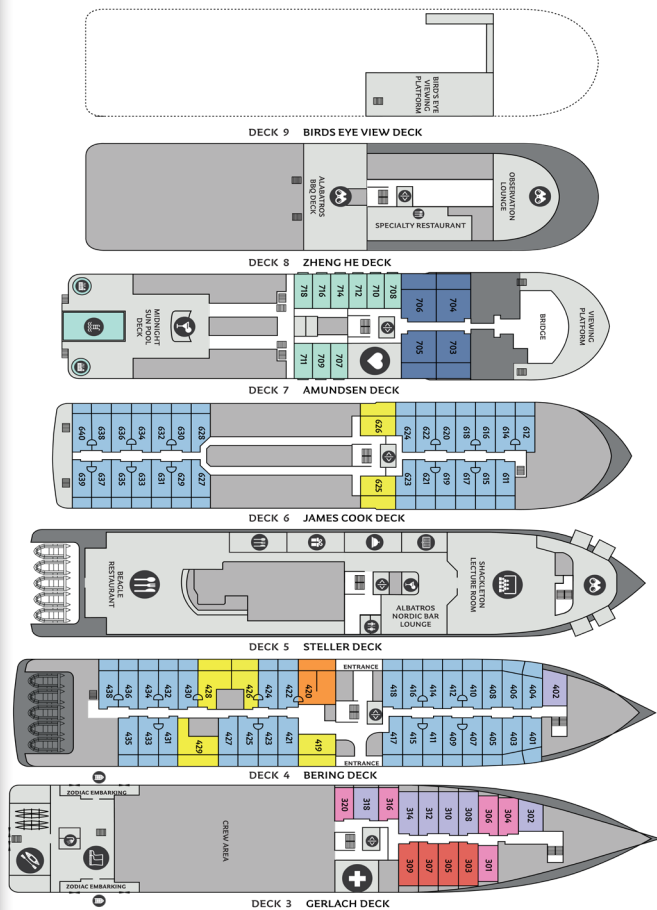

## FACILITIES

- 2 Restaurants and 1 Open Deck Dining
- Observation Lounge
- Lecture Lounge
- Piano Bar
- Gym, Spa & Sauna Facilities
- Polar Library
- Albatros Ocean Boutique
- Changing Facilities for Zodiac Excursions
- 18 Zodiacs
- Pool Bar

- Premium Suite, Two Bedroom Cabin**  
1 Cabin, Size 45 sqm incl. Balcony
- Category C, Balcony State Cabin**  
57 Cabins, Size 24 sqm incl. Balcony
- Category F, Triple Porthole Cabin**  
4 Cabins, Size 22 sqm
- Category A, Junior Suite**  
4 Cabins, Size 42 sqm incl. Balcony
- Category D, Albatros State Porthole Cabin**  
7 Cabins, Size 22 sqm
- Category G, Porthole Single Cabin**  
5 Cabins, Size 18 sqm
- Category B, Balcony Suite**  
6 Cabins, Size app. 32 sqm incl. Balcony
- Category E, French Balcony C**  
9 Cabins, Size 16 sqm

- Restaurant
- Knud Rasmussen Library
- Fitness
- Mudroom
- Elevator
- Bar
- Albatros Ocean Boutique
- Albatros Polar Spa
- Zodiac embarking
- Shower
- Observation Area
- Reception
- Infinity Pool
- Kayak platform
- Stairs
- Shackleton Lecture Room
- Medical Clinic
- Jacuzzi
- Toilet

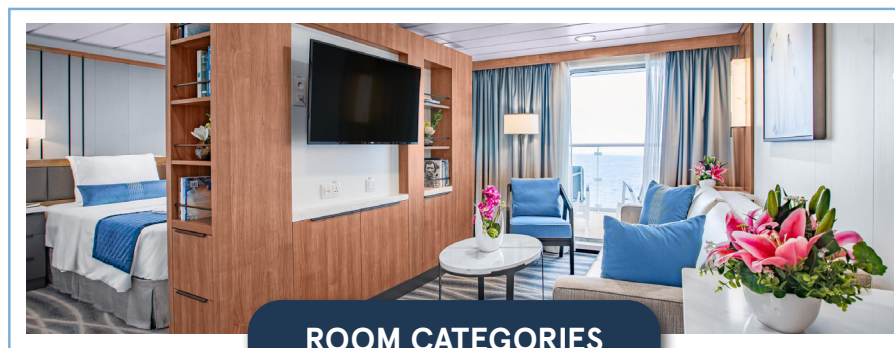

## ROOM CATEGORIES



**CATEGORY PS**  
Polar Premium Suite (1)  
45 sqm, incl. Balcony

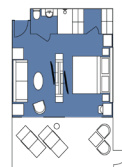

**CATEGORY A**  
Junior Suite (4)  
42 sqm, incl. Balcony



**CATEGORY B**  
Balcony Suite (6)  
app. 32 sqm, incl. Balcony



**CATEGORY C**  
Balcony State Cabin (57)  
24 sqm, incl. Balcony



**CATEGORY D**  
Albatros State Cabin (7)  
22 sqm, Porthole



**CATEGORY E**  
French Balcony Suite (9)  
16 sqm, French Balcony



**CATEGORY F**  
Triple Cabin (4)  
22 sqm, Porthole



**CATEGORY G**  
Single Cabin (5)  
18 sqm, Porthole

