



# THE ULTIMATE ANTARCTICA EXPERIENCE - QUEST FOR THE CIRCLE

Experience incredible wildlife, stunning scenery and gigantic icebergs

12 Days

From Ushuaia

M/V Ocean Albatros

Dec 15, 2024

Adventure Options



Storied and sought for centuries, the great White Continent beckons intrepid modern-day explorers from all over the world. Experience incredible wildlife, stunning scenery and gigantic icebergs in action-packed days on the Last Continent on our 12-day ultimate Antarctica expedition experience.

Join us onboard our purpose-built, ice-class expedition vessel Ocean Albatros to experience the majesty and wonder of Earth's last frontier up close and personal. Our vessels enable us to get closer to nature, with a fleet of Zodiac landing craft, a team of experienced expert expedition guides, and the Antarctic Peninsula as our spectacular destination.

Departing Argentina's southernmost city of Ushuaia, we cross the mighty Drake Passage en-route to the South Shetland Islands, aiming to arrive on the afternoon of the third day of our voyage (weather permitting). Continuing southward from the South Shetland Islands, we will delve deeper into the inlets and bays of the Antarctic Peninsula, entering the famous Gerlache Strait, where glittering ice cliffs and precipitous peaks rise straight out of the frigid water. Icebergs, glaciers, mountains and rugged snowfields characterise this wildly beautiful alien landscape.

From the 'mainland' of the Peninsula, we set off southwards, aiming for the Antarctic Circle at 66°33' South - a goal which has eluded many of the talented and driven explorers of yesteryear. Watch as the sun circles your vessel, never quite setting at this extreme latitude. This voyage has no set itinerary beyond the aim to reach the Circle - however, we always aim to visit locations which showcase the best of Antarctica; wildlife sightings and weather conditions will decide the exact sites we visit as we move with the rhythms of nature; perhaps a well known penguin colony will draw us west, and whale and seal sightings will draw us back again! Wherever the whims of Mother Nature take us, jaw-dropping scenery and landscapes are guaranteed!

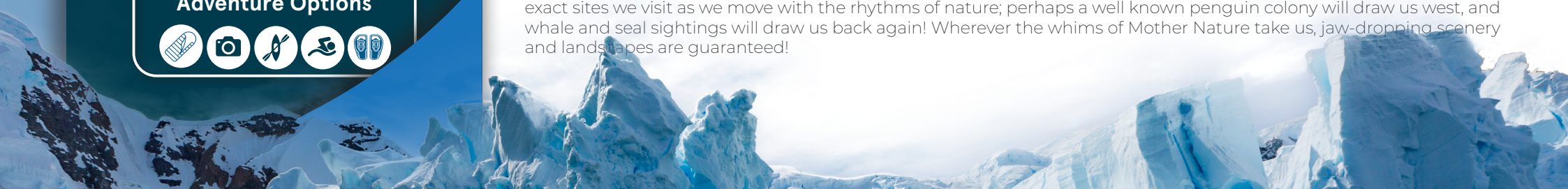



# ITINERARY

- DAY 1** Arrival In Ushuaia, Embarkation
- DAY 2** At Sea - Crossing The Drake Passage Southbound
- DAY 3** At Sea - Crossing The Drake Passage Southbound
- DAY 4-9** The Antarctic Peninsula - Adventure Awaits
- DAY 10** At Sea - Crossing The Drake Passage Northbound
- DAY 11** At Sea - Crossing The Drake Passage Northbound
- DAY 12** Back To Ushuaia And Disembarkation



## INCLUSIONS

- 12-day/11-night cruise with accommodation in a shared double stateroom featuring ensuite facilities
- Embarkation shuttle transfer to the vessel from Ushuaia city centre
- Shuttle transfer after disembarkation from the ship to Ushuaia city centre or airport
- All Zodiac landings and excursions, as per itinerary, guided by our Expedition Team
- Expedition parka
- Rubber boots loan scheme
- Briefings and lectures by our Expedition Leader and Team
- English-speaking Expedition Team
- Full board on the ship - breakfast, lunch, dinner and snacks
- Complimentary house wine, beer and soda at dinner (selected labels and brands, served at our a-la-carte dinners)
- Free tea and coffee available 24 hours
- Taxes and landing fees
- Special photo workshops
- Welcome and Farewell Cocktail Parties
- Digital visual journal link distributed after the voyage, including voyage log, gallery, species list and more!



## A TYPICAL DAY

- After crossing the Drake Passage, you'll be exploring Antarctica. The goal for the days around the South Shetland islands and Antarctic peninsula is to offer activities which will allow everyone to explore off the ship as much as possible (weather permitting). Weather dependent, we will try to offer two activities per day, usually either a landing or a Zodiac cruise.
- A "TYPICAL" EXPEDITION DAY MAY LOOK LIKE THIS (SUBJECT TO WEATHER AND SEA CONDITIONS AND SAILING SCHEDULE):
- 06.45: Wake-up call
- 07.00-08.00: Breakfast
- 08.30-11.30: Morning activity - landing and/or Zodiac cruise
- 12.30-13.30: Lunch during vessel repositioning
- 14.30-17.30: Afternoon Activity - landing and/or Zodiac cruise
- 18.30-19.30: Evening Recap and Briefing with the Expedition Team
- 19.30: Dinner
- 21.00: Evening entertainment or presentations with the Expedition Team.

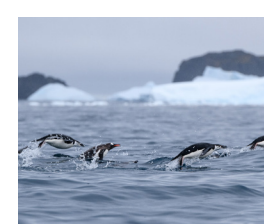

# OCEAN ALBATROS DECKPLAN

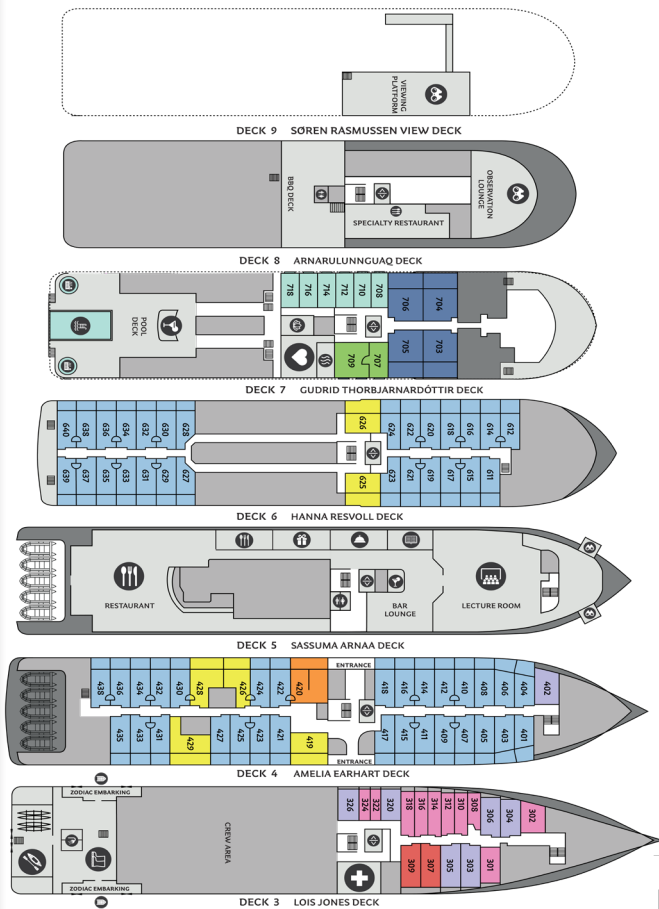

## FACILITIES

- 2 Restaurants and 1 Open Deck Dining
- Observation Lounge
- Lecture Lounge
- Piano Bar
- Gym, Spa & Sauna Facilities
- Polar Library
- Albatros Ocean Boutique
- Changing Facilities for Zodiac Excursions
- 18 Zodiacs
- Jacuzzies and Pool Bar

- Brynhilde Suite, Two Bedroom Suite**  
1 Cabin, Size 52 sqm, French Balcony
- Category B, Balcony Suite**  
6 Cabins, Size app. 32 sqm incl. Balcony
- Category E, French Balcony Stateroom**  
6 Cabins, Size 16 sqm
- Freydis Suite**  
1 Cabin, Size 43 sqm incl. Balcony
- Category C, Balcony Stateroom**  
57 Cabins, Size 22 sqm incl. Balcony
- Category F, Porthole Triple Stateroom**  
2 Cabins, Size 20 sqm
- Category A, Junior Suite**  
4 Cabins, Size 40 sqm incl. Balcony
- Category D, Porthole Stateroom**  
7 Cabins, Size 16 sqm
- Category G, Porthole Single Stateroom**  
10 Cabins, Size 13 sqm

- Restaurant
- Knud Rasmussen Library
- Fitness
- Mudroom
- Sauna
- Bar
- Albatros Ocean Boutique
- Albatros Polar Spa
- Zodiac embarking
- Elevator
- Observation Area
- Reception
- Infinity Pool
- Kayak platform
- Shower
- Shackleton Lecture Room
- Medical Clinic
- Jacuzzi
- Toilet
- Stairs



## ROOM CATEGORIES

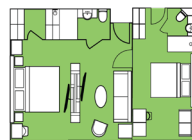

**Brynhilde Suite BS**  
Two Bedroom Suite (1)  
52 sqm, French Balcony



**Freydis Suite FS**  
Premium Suite (1)  
43 sqm, incl. Balcony

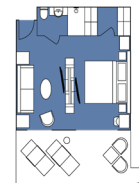

**CATEGORY A**  
Junior Suite (4)  
40 sqm, incl. Balcony



**CATEGORY B**  
Balcony Suite (6)  
app. 32 sqm, incl. Balcony



**CATEGORY C**  
Balcony Stateroom (57)  
app. 22 sqm, incl. Balcony



**CATEGORY D**  
Porthole Stateroom (7)  
16 sqm, Porthole



**CATEGORY E**  
French Balcony Stateroom (6)  
16 sqm, French Balcony



**CATEGORY F**  
Triple Stateroom (2)  
20 sqm, Porthole



**CATEGORY G**  
Single Stateroom (10)  
13 sqm, Porthole

